



AS1 AC Retrofit Battery System

7000⁺ GLOBAL APPLICATIONS
25%⁺ MARKET SHARE IN AUSTRALIA



Quick storage retrofit on existing PV plants



Built-in 5.1kWh lithium battery (extendable)



Compatible with all inverter brands



With UPS function, switch time $\leq 10\text{ms}$



AS1-3KS-5.1

GUANGZHOU SANJING ELECTRIC CO., LTD.

Website: www.saj-electric.com

E-mail: info@saj-electric.com

Add: SAJ Innovation Park, No.9, Lizhishan Road, Science City, Guangzhou, Guangdong, P.R.China.



AS1 AC Retrofit Battery System

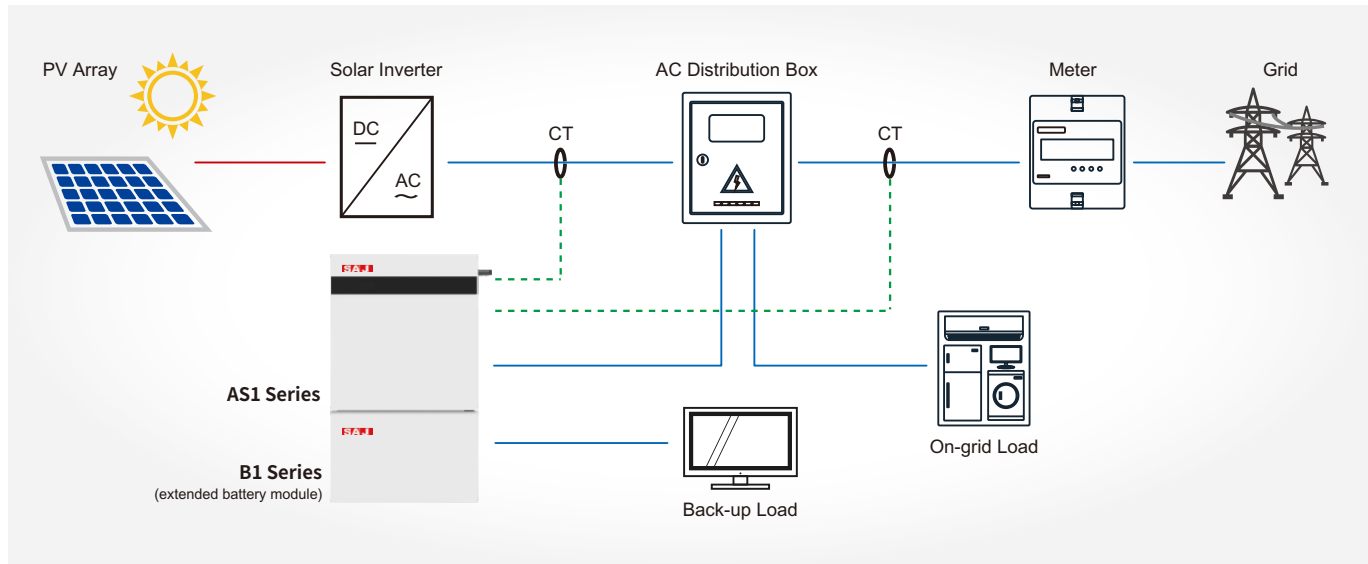

AS1 Series

Type	AS1-3KS-5.1	AS1-3KS-10.2	AS1-3KS-15.3	AS1-3KS-20.4
Battery Parameters				
Battery Type	Lithium ion			
Total Energy Capacity [Wh]	5120	10240	15360	20480
Battery Capacity [Ah]	100	200	300	400
Rated Voltage [V]	51.2			
Voltage range [V]	42~58.4			
Depth Of Discharge [DOD]	≤90%			
Cycle Life	≥6000			
Max.Charge Current [A]	60			
Max.Discharge Current [A]	60			
Scalability	AS1	AS1+B1	AS1+2*B1	AS1+3*B1
Grid Parameters				
Max.Continuable Output Power [VA]	3000			
Max.Output Current [A]@230Vac	13.1			
Rated Grid/Backup Voltage/Range [V]	220, 230, 240/180~280			
Rated Grid/Backup Frequency/Range [Hz]	50, 60/±5			
Power factor [cos φ]	0.8 leading~0.8 lagging			
Feed-in	L+N+PE			
AC Output [Back-up Mode]				
Max. Continuable Output Power [VA]	3000			
Output Voltage [V]	220/230/240			
Max.Output Current [A]@230Vac	13.1			
Output Frequency [Hz]	50/60			
Max.Output Power [VA]	3600 ,10sec			
General Data				
Communication Mode	Wi-Fi/4G/Ethernet (Optional)			
Operating Temperature Range	0°C~50°C (above 45 °C battery performance degrades)			
Cooling Method	Natural Convection			
Ambient Humidity	0-95% Non-condensing			
Noise [dBA]	<29			
Ingress Protection	IP65			
Dimensions [H*W*D][mm]	738*650*186			
Weight [kg]	64			
Standard Warranty [Year]	5 (Standard) /10 (Optional)			
Applicable Standard	AS 4777.2, VDE 4105, G98, C10/C11, CEI0-21, IEC62619, IEC62040			